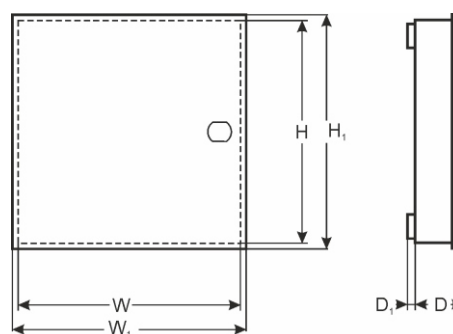

CODE: **AWO249****TECHNICAL DATA**

<b>External dimensions of the enclosure:</b>	W=320, H=305, D+D1=90+8 [+/-2 mm]
<b>External dimensions of the front panel:</b>	W1=325, H1=310 [+/-2 mm]
<b>Weight net/gross:</b>	1,9kg / 2,1kg [+/-0,1kg]
<b>Operating environment:</b>	class II, -10°C÷ 40°C
<b>Material description:</b>	sheet steel DC01, thickness: 0,7mm, protection anticorrosion, color: RAL 9003
<b>Destination:</b>	indoor
<b>Tamper protection:</b>	1 x microswitch: opening, 0,5 A@50 V DC max. NC
<b>Closing:</b>	screwed x 4
<b>Notes:</b>	optional: lockable, distance from wall (mounting surface) - 8mm, easy door removal
<b>Declaration, warranty:</b>	CE, 2 year from the production date